



## **LIMITED ACCESS CONTROL CHANGE FOR I-95/395 HOT LANES**

Malcolm T. Kerley, P.E.  
Chief Engineer  
June 18, 2009

# Limited Access Control Changes (LACC)

- **§ 33.1-57 of the Code of Virginia, the designation of which requires the CTB to extinguish all easements of access, light or air**
  - **Actions regarding limited access control, including changes in control**
  - **These changes typically include shifting, moving, or breaking control, or any combination of these, after a project is completed, finalized and serving in its intended capacity**
  - **The CTB will not consider a change in limited access control without written determination from the Chief Engineer**

# DETERMINATION OF NEED

- **As a result of continued design development and refinement of Route 95/395 Hot Lane Project, numerous changes to existing limited access control is required**
- **Resolve unknowns from Project for PPTA Developer**
- **Necessary as part of the project development process**

# Lorton In-line BRT Station and PED access

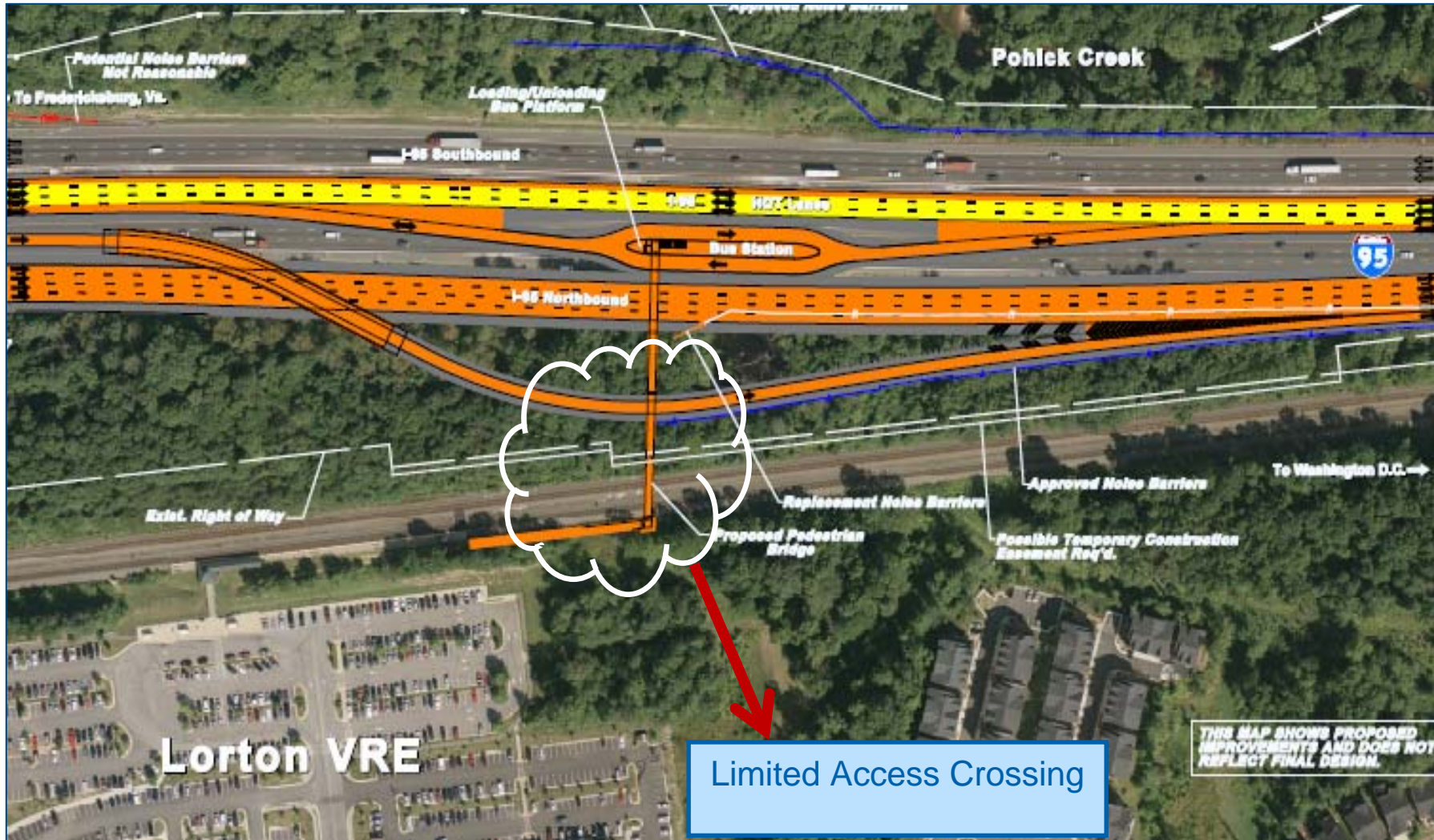



# New Access to at Seminary Road





# New Access at Shirlington Road

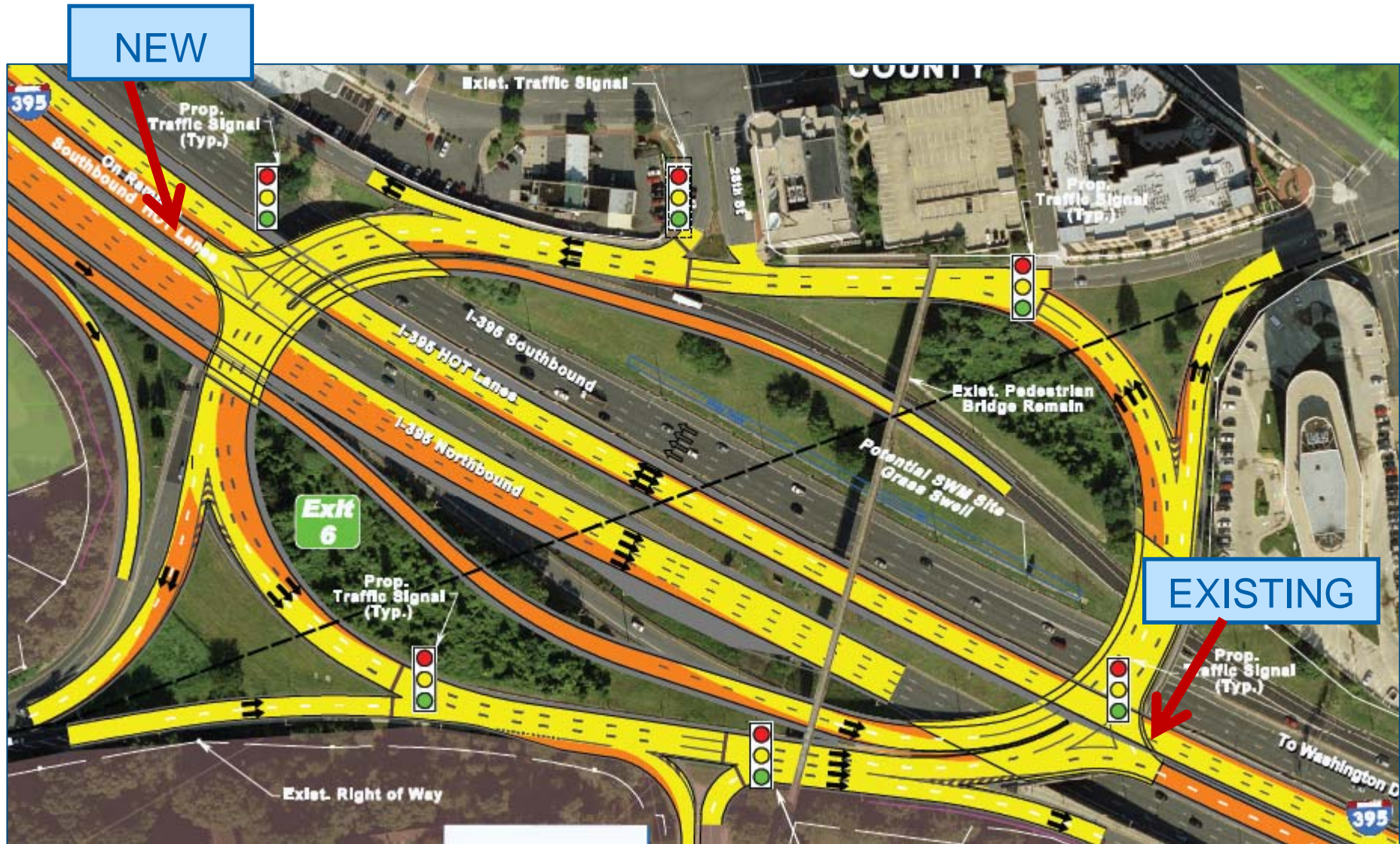



## **LIMITED ACCESS CONTROL CHANGE FOR I-95/395 HOT LANES**

Malcolm T. Kerley, P.E.  
Chief Engineer  
June 18, 2009