



# COMMONWEALTH of VIRGINIA

## *Commonwealth Transportation Board*

Shannon Valentine  
Chairperson

1401 East Broad Street  
Richmond, Virginia 23219

(804) 786-2701  
Fax: (804) 786-2940

*Agenda item # 4*

### RESOLUTION OF THE COMMONWEALTH TRANSPORTATION BOARD

June 17, 2020

#### MOTION

**Made By:** Mr. Malbon., **Seconded By:** Mr. Miller.  
**Action:** Motion Carried, Unanimously

**Title:** Locality Land Conveyances, Various Streets,  
City of Chesapeake

**WHEREAS**, Section 33.2-907(C) of the *Code of Virginia* authorizes the Commonwealth Transportation Board, upon petition of a local governing body, to transfer real estate acquired incidental to the construction, reconstruction, alteration, maintenance or repair of the primary state highway system that constitutes a section of public highway to the local governing body, and upon such transfer such section of highway shall cease being a part of the primary state highway system; and

**WHEREAS**, the City of Chesapeake has requested the conveyance of the right of way for a portion of Military Highway and a portion Gallsberry Road (formerly Military Highway), currently in the City's street system; and

**WHEREAS**, the City is maintaining, as part of the City's urban street system, the portions of Routes 13, 17 and 299 that are set forth in the attached *Plan and Profile of Proposed State Highway* for Projects 1115 A-1W; 1284, Sections A-1 and B-2; 1284A-2, Section B-6; 1284A-4, Section B-1; 1664-02; 0013-064-101; 1115, Sections A-1, A-1S, B-1, A-2 and A-2S; 1115, Sections C, D and E; 1664-03; 1664-08; 1664-11; 1664-12; 1664-15; 2064-05; 0017-064-002(Old Project 2064-02) (Exhibit A) and are the subject of the requested transfer/conveyance; and

**WHEREAS**, the proposed conveyance has been reviewed and approved by the Director of Right of Way and Utilities.

**NOW, THEREFORE, BE IT RESOLVED**, that in accordance with the provisions of Section 33.2-907(C) of the *Code of Virginia*, as amended, conveyance of the right of way/land requested and shown on Exhibit A is approved as set forth and upon conveyance, the portions of the roads so conveyed shall no longer be a part of the primary state highway system.

Resolution of the Board  
Proposed Locality Land Conveyance  
Military Highway  
City of Chesapeake  
June 17, 2020  
Page Two

**BE IT FURTHER RESOLVED**, the Commissioner of Highways is hereby authorized to execute, in the name of the Commonwealth, a deed or deeds conveying the right of way/real estate subject to such restrictions as may be deemed appropriate and to take such other actions as necessary to implement such conveyance.

**CTB Decision Brief**  
**Title: Locality Land Conveyances, Various Streets,**  
**City of Chesapeake**

**Issue:** The City of Chesapeake (the “City”) has requested the transfer and conveyance of the right of way for Routes 13, 17 and 299 [Military Highway and Gallsberry Road (formerly Military Highway)] to the City. Such routes were acquired and constructed as a part of Routes 13, 17 and 299, Project 1115 A-1W; 1284, Sections A-1 and B-2; 1284A-2, Section B-6; 1284A-4, Section B-1; 1664-02; 0013-064-101; 1115, Sections A-1, A-1S, B-1, A-2 and A-2S; 1115, Sections C, D and E; 1664-03; 1664-08; 1664-11; 1664-12; 1664-15; 2064-05; 0017-064-002 (Old Project 2064-02). The requested conveyance requires approval by the CTB pursuant to section 33.2-907 (C) of the *Code of Virginia*.

**Facts:** The City of Chesapeake is maintaining, as part of the City’s urban street system, the portions of Routes 13, 17 and 299 that are set forth in the attached *Plan and Profile of Proposed State Highway* for Projects 1115 A-1W; 1284, Sections A-1 and B-2; 1284A-2, Section B-6; 1284A-4, Section B-1; 1664-02; 0013-064-101; 1115, Sections A-1, A-1S, B-1, A-2 and A-2S; 1115, Sections C, D and E; 1664-03; 1664-08; 1664-11; 1664-12; 1664-15; 2064-05; 0017-064-002(Old Project 2064-02) (Exhibit A) and are the subject of the requested transfer/conveyance.

Pursuant to Section 33.2-907(C) of the *Code of Virginia*, the Commonwealth Transportation Board, upon petition of a local governing body, may transfer real estate acquired incidental to the construction, reconstruction, alteration, maintenance or repair of the primary state highway system, which constitutes a section of public highway to the local governing body, and upon such transfer such section of road shall cease being a part of the primary state highway system.

This proposed conveyance has been reviewed and approved by the Director of Right of Way and Utilities..

**Recommendations:** VDOT recommends that the right of way/real estate be conveyed to the City of Chesapeake for public street purposes and continued inclusion and maintenance by the City as part of the City’s urban street system.

**Action Required by CTB:** The *Code of Virginia* requires a majority vote of the Commonwealth Transportation Board (CTB) to approve the conveyance. The CTB will be presented with a resolution for a formal vote.

**Result, if Approved:** If said resolution is approved, the right of way/real estate will be conveyed to the City of Chesapeake.

**Options:** Approve, Deny, or Defer

**Public Comments/Reactions:** None



City of Chesapeake  
Department of Public Works  
Right-of-Way Office  
Post Office Box 15225  
Chesapeake, Virginia 23328-5225  
(757) 382-6101

November 15, 2013

Vicky W. Pinchbeck, Project Manager  
Commonwealth of Virginia  
Department of Transportation  
Right of Way and Utilities  
1750 North Main Street  
Suffolk, Virginia 23434

**RE: REQUESTING THE TRANSFER OF MILITARY HIGHWAY RIGHT OF WAY  
TO THE CITY OF CHESAPEAKE, VA**

Dear Ms. Pinchbeck:

The City of Chesapeake is requesting the transfer of the Right of Way along Route 13, Military Highway from the City of Suffolk Corporate Line to the City of Virginia Beach Corporate Line.

Included is a copy of a resolution requesting the transfer of Right of Way along U.S. Route 13, Military Highway, from 0.225 Miles East of the Intersection of Route 58 to 7.254 Miles East of the intersection of Route 58 to the City of Chesapeake, to include improvements to the intersection of U.S. Route 13, Military Highway and U.S. Route 17.

Please find attached a copy of the resolution, plus a list of all state projects along Route 13, the cover sheets, Right of Way Data sheets and deed transfers to the Department of Transportation.

Sincerely yours,

A handwritten signature in cursive script that reads "Carole Gillespie".

Carole A.F. Gillespie  
Right-of-Way Agent

Attachment



City of Chesapeake  
Department of Public Works  
Right-of-Way Office  
Post Office Box 15225  
Chesapeake, Virginia 23328-5225  
(757) 382-6101  
Fax (757) 382-8207

March 22, 2010

Vicky W. Pinchbeck,  
Property Manager  
Commonwealth of Virginia  
Department of Transportation  
Right of Way and Utilities  
1750 North Main Street  
Suffolk, Virginia 23434

**RE: ROUTE 13, MILITARY HIGHWAY AND INCLUDING THE INTERSECTION OF U.S. ROUTE 13, MILITARY HIGHWAY, AND U.S. ROUTE 17.**

Dear Ms. Pinchbeck:

The City of Chesapeake is requesting the transfer to the City of Chesapeake the Right of Way along U.S. Route 13, Military Highway, from 0.225 Miles East of the Intersection of Route 58 to 7.254 Miles East of the intersection of Route 58 to the City of Chesapeake to include improvements to the intersection of U.S. Route 13, Military Highway, and U. S. Route 17.

Included is a copy of the resolution requesting the transfer from the City of Chesapeake, plan sheets plus a deed on one of the properties. Per request, I researched the Highway Department location on Military Highway and was unable to locate other plan sheets relating to this strip.

Sincerely,

A handwritten signature in cursive script that reads "Carole Gillespie".

Carole Gillespie, Right of Way Agent

Attachments

FILE	PROJ #	PROJECT DESCRIPTION
A2301	1115	<u>NORFOLK CO: FR 1.187 MI E OF INT RT 58 NEAR BOWERS HILL TO INT RT 27</u>
A2361	1284A-1	<u>NORFOLK &amp; PRINCESS ANNE COUNTIES: FR: INT RTS 13 &amp; 170 TO INT RT 58 NORFOLK BY-PASS</u>
A2393	1284A-2B 1284A-4B	<b>NORFOLK CO:</b> FR 0.388 MI W INT RT 460 & 166Y TO 1.945 M E INT RT 460 & 166Y NORFOLK BY-PASS
A4309	1664-10	<u>NORFOLK CO: FR 0.081 MI S OF INT RTES 13 &amp; 165 TO 0.125 MI N OF INT RTES 13 &amp; 165</u>
A4422	1664-09	NORFOLK CO: FR 0.070 MI W INT RTE 17 TO 0.105 MI E INT RTE 17
A4959	1675-03 1664-02 1675 -01	<u>PRINCESS ANNE AND NORFOLK COS:</u> <u>FR 1.715 MI E NORFOLK – PRINCESS ANNE CO LINE TO 0.364 MI W NORFOLK – PRINCESS ANNE CO LINE</u> (OLD PROJ 574 CW-1 R-3, CW-1 R4) BRIDGE OVER WRIGHT’S LAKE (OLD 574 B-1) FR 0.390 MI E NORFOLK-PRINCESS ANNE CO LINE TO 0.005 MI E NORFOLK-PRINCESS ANNE CO LINE (OLD 574 CW-1 R-1)
A5006	1664-04 1675-02 1664-05 1675-06 1675-08	<u>NORFOLK &amp; PRINCESS ANNE COUNTIES:</u> <u>FR 0.188 MI E INT RTES 460 &amp; 166Y TO 0.186 MI N PRINCESS ANNE - NORFOLK CO LINE</u> (OLD LA 1264) FR NORFOLK–PRINCESS ANNE CO LINE TO PRINCESS ANNE–NORFOLK CO LINE (OLD LA 1284 1277) FR: PRINCESS ANNE–NORFOLK CO LINE TO 0.186 MI N PRINCESS ANNE-NORFOLK CO LINE(OLD LA 1277) FR NORTH END OF EAST N BR ELIZ RIVER BR TO 0.500 MI N NORTH END OF EAST N BR ELIZ RIVER BR) FR INT RTE 13 & 58 TO 0.119 MI SO ??
	0013-131-104 C501 0013-131-104 RW202	<u>FR 0.220 MI W CAROLINA-NORTHWESTERN RAILWAY TO: 0.293 MI E CAROLINA-NORTHWESTERN RAILWAY MILITARY HWY</u>
	0064-131-105 C501	<u>PROPOSED INTERCHANGE WITH RTE 460 &amp; BUSINESS RTE 13 (SO MILITARY HWY)</u>
	0013-131-106 C501 0013-131-111 C501	<u>PROPOSED SIGNAL MODIFICATION AT INTERSECTION OF ROUTE 13/MILITARY HIGHWAY AND ROUTE I-64 WB OFF RAMP (EXIT 297)</u>
A1521	0013-064-111 5a12	<u>NORFOLK COUNTY: FR 1.678 MI E RT 58 AT BOWERS HILL TO INT RT 27</u>
A1845	0013-006-000-1115 cde	<u>NORFOLK COUNTY: FR INT RT 58 NEAR BOWERS HILL TO 1.679 MI E INT RT 58</u>
A24523	0664-131-101 C501	<u>FR: 0.68 MI N RTE 58 (WBL) TO 0.44 MI S RTE 58 (WBL) BOWERS HILL INTERCHANGE PHASE II</u>

	7013-131-V03 C501	<u>ROUTE 13 (MILITARY HIGHWAY) FR: 0.417 MILE WEST OF GILMERTON BRIDGE TO: 0.356 MILE EAST OF GILMERTON BRIDGE</u>
<b>FILE</b>	<b>PROJ #</b>	<b>PROJECT DESCRIPTION</b>
A5640	0013-064-003 1664-08  0017-064-002 2064-05 1664-11  F-024-4(1)/ 1664-12  1664-15	<u>NORFOLK CO: FR: 0.255 MI E OF INT RTE 58 NEAR BOWERS HILL TO 7.254 MI E OF INT RTE 58</u>  FR: 5.277 MI E OF INT RTE 58 NEAR BOWERS HILL TO 5.945 MI E OF INT RTE 58 BROADMOOR DESCRIPTION AS PART OF THE SAME PROJECT WITH NEW NUMBER  SPEC DES OVERPASS RT 17 OVER RTE 13 FR: 6.277 MI E OF INT RTE 58 TO: 6.419 MI E OF INT RTE 58 (RIGHT AND LEFT TURNING LANES) FR: 4.572 MI E OF INT RTE 58 NEAR BOWERS HILL TO 5.277 MI E OF INT RTE 58 FR: 5.077 MI E OF INT RTE 58 NEAR POWERS HILL TO 5.421 MI E OF INT RTE 58 NEAR MOWERS HILL
A6137	001-064-013 1664-13 1664-14	<u>NORFOLK CO: LEFT TURN LANES AT INTERSECTIONS OF ROUTES 13 &amp; 196 AND 13 &amp; 644</u> FR: 0.071 MI W INT RTE 13 & 196 TO 0.074 MI E INT RTE 13 & 196 FR: 0.676 MI W INT RTE 13 & 170 TO: 0.527 MI W INT RTE 13 & 170
A6551	0013-064-103 F701	<u>NORFOLK COUNTY FLASHING LIGHT SIGNAL N &amp; P BELT LINE RR NEAR GILMERTON</u>
A6563	0013-064-002 2064-02	<u>NORFOLK COUNTY FR: 0.151 MI N OF INT RTE 13 TO 0.152? MI S OF INT RTE 13</u>
A7926	0464-131-101 RW202	<u>FR 0.929 MI N INTERSECTION RTE 64 TO: 0.183 MI SOUTH OF PARK AVE</u>
A9331	6013-131-101	<u>FR: 2.962 MI W OF W.C.L. OF CHESAPEAKE TO: 1.592 MI E OF E.C.L. OF NANSEMOND</u>
A21012	6013-131-102	<u>FR: 1.592 MI E OF E.C.L. OF SUFFOLK TO: 0.328 MI E INT RTE 264 &amp; EXIST RTE 13 (BOWERS HILL INTERCHANGE)</u>

10-2-04  
**RESOLUTION REQUESTING THE VIRGINIA DEPARTMENT OF TRANSPORTATION TO CONVEY ITS INTEREST IN A PORTION OF U.S. ROUTE 13, MILITARY HIGHWAY, FROM 0.225 MILES EAST OF THE INTERSECTION OF ROUTE 58 TO 7.254 MILES EAST OF THE INTERSECTION OF ROUTE 58 TO THE CITY OF CHESAPEAKE.**

**WHEREAS**, Section 33.1-89 of the Code of Virginia provides that whenever the Commissioner of Transportation for the Commonwealth of Virginia has acquired property for road projects pursuant to a request of the municipality, the Commissioner is authorized to convey all title and interest so acquired to the municipality in accordance with the terms of agreement between the Commonwealth and the municipality, which includes the property used for the road projects; and,

**WHEREAS**, the Virginia Department of Transportation previously completed State Project 1664-15 (Construction), 1664-03, 2064-02-05, and 0017-0064-002, which provided improvements to the intersection of U.S. Route 13, Military Highway, and U.S. Route 17.

**NOW, THEREFORE, BE IT RESOLVED** by the Council of the City of Chesapeake, Virginia, that it hereby requests the Virginia Department of Transportation to convey to the City of Chesapeake all title and interest which the Commonwealth may have in the portion of Route 13, Military Highway, State Project 1664-15 (Construction), 1664-03, 2064-02-05 (Original Project 115A-1A-1S, A-1W), Old LA 1115, and State Project 0017-0064-002, from 0.225 miles east of the intersection of Route 58 to 7.254 miles east of the intersection of Route 58, as depicted on Exhibit A.



ADOPTED by the Council of the City of Chesapeake, Virginia, this 26th day of  
January, 2010.

APPROVED:

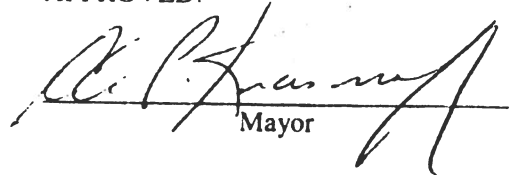
  
Mayor

ATTEST:

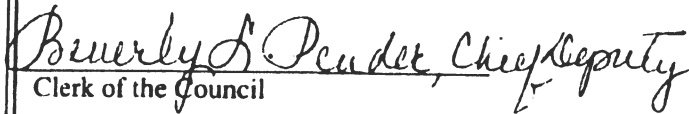
  
Clerk of the Council

FILE	PROJ #	PROJECT DESCRIPTION
A2301	1115	<u>NORFOLK CO: FR 1.187 MI E OF INT RT 58 NEAR BOWERS HILL TO INT RT 27</u>
A2361	1284A-1	<u>NORFOLK &amp; PRINCESS ANNE COUNTIES: FR: INT RTS 13 &amp; 170 TO INT RT 58 NORFOLK BY-PASS</u>
A2393	1284A-2B 1284A-4B	<u>NORFOLK CO: FR 0.388 MI W INT RT 460 &amp; 166Y TO 1.945 M E INT RT 460 &amp; 166Y NORFOLK BY-PASS</u>
A4309	1664-10	<u>NORFOLK CO: FR 0.081 MI S OF INT RTES 13 &amp; 165 TO 0.125 MI N OF INT RTES 13 &amp; 165</u>
A4422	1664-09	<u>NORFOLK CO: FR 0.070 MI W INT RTE 17 TO 0.105 MI E INT RTE 17</u>
A4959	1675-03 1664-02 1675 -01	<u>PRINCESS ANNE AND NORFOLK COS:</u> <u>FR 1.715 MI E NORFOLK – PRINCESS ANNE CO LINE TO 0.364 MI W NORFOLK – PRINCESS ANNE CO LINE (OLD PROJ 574 CW-1 R-3, CW-1 R4)</u> BRIDGE OVER WRIGHT’S LAKE (OLD 574 B-1) FR 0.390 MI E NORFOLK-PRINCESS ANNE CO LINE TO 0.005 MI E NORFOLK- PRINCESS ANNE CO LINE (OLD 574 CW-1 R-1)
A5006	0013-064-101 1664-04 1675-02 1664-05 1675-06 1675-08	<u>NORFOLK &amp; PRINCESS ANNE COUNTIES:</u> <u>FR 0.188 MI E INT RTES 460 &amp; 166Y TO 0.186 MI N PRINCESS ANNE - NORFOLK CO LINE (OLD LA 1264)</u> FR NORFOLK–PRINCESS ANNE CO LINE TO PRINCESS ANNE–NORFOLK CO LINE (OLD LA 1284 1277) FR: PRINCESS ANNE–NORFOLK CO LINE TO 0.186 MI N PRINCESS ANNE- NORFOLK CO LINE(OLD LA 1277) FR NORTH END OF EAST N BR ELIZ RIVER BR TO 0.500 MI N NORTH END OF EAST N BR ELIZ RIVER BR) FR INT RTE 13 & 58 TO 0.119 MI SO ??
	0013-131- 104 C501 0013-131- 104 RW202	<u>FR 0.220 MI W CAROLINA-NORTHWESTERN RAILWAY TO: 0.293 MI E CAROLINA-NORTHWESTERN RAILWAY MILITARY HWY</u>
	0064-131- 105 C501	<u>PROPOSED INTERCHANGE WITH RTE 460 &amp; BUSINESS RTE 13 (SO MILITARY HWY)</u>
	0013-131- 106 C501 0013-131- 111 C501	<u>PROPOSED SIGNAL MODIFICATION AT INTERSECTION OF ROUTE 13/MILITARY HIGHWAY AND ROUTE I-64 WB OFF RAMP (EXIT 297)</u>
A1521	0013-064- 111 5a12	<u>NORFOLK COUNTY: FR 1.678 MI E RT 58 AT BOWERS HILL TO INT RT 27</u>
A1845	0013-006- 000-1115 cde	<u>NORFOLK COUNTY: FR INT RT 58 NEAR BOWERS HILL TO 1.679 MI E INT RT 58</u>
A24523	0664-131- 101 C501	<u>FR: 0.68 MI N RTE 58 (WBL) TO 0.44 MI S RTE 58 (WBL) BOWERS HILL INTERCHANGE PHASE II</u>

	7013-131-V03 C501	<u>ROUTE 13 (MILITARY HIGHWAY) FR: 0.417 MILE WEST OF GILMERTON BRIDGE TO: 0.356 MILE EAST OF GILMERTON BRIDGE</u>
<b>FILE</b>	<b>PROJ #</b>	<b>PROJECT DESCRIPTION</b>
A5640	0013-064-003 1664-08  0017-064-002 2064-05 1664-11  F-024-4(1)/ 1664-12  1664-15	<u>NORFOLK CO: FR: 0.255 MI E OF INT RTE 58 NEAR BOWERS HILL TO 7.254 MI E OF INT RTE 58</u>  FR: 5.277 MI E OF INT RTE 58 NEAR BOWERS HILL TO 5.945 MI E OF INT RTE 58 BROADMOOR DESCRIPTION AS PART OF THE SAME PROJECT WITH NEW NUMBER  SPEC DES OVERPASS RT 17 OVER RTE 13 FR: 6.277 MI E OF INT RTE 58 TO: 6.419 MI E OF INT RTE 58 (RIGHT AND LEFT TURNING LANES) FR: 4.572 MI E OF INT RTE 58 NEAR BOWERS HILL TO 5.277 MI E OF INT RTE 58 FR: 5.077 MI E OF INT RTE 58 NEAR POWERS HILL TO 5.421 MI E OF INT RTE 58 NEAR MOWERS HILL
A6137	001-064-013 1664-13 1664-14	<u>NORFOLK CO: LEFT TURN LANES AT INTERSECTIONS OF ROUTES 13 &amp; 196 AND 13 &amp; 644</u> FR: 0.071 MI W INT RTE 13 & 196 TO 0.074 MI E INT RTE 13 & 196 FR: 0.676 MI W INT RTE 13 & 170 TO: 0.527 MI W INT RTE 13 & 170
A6551	0013-064-103 F701	<u>NORFOLK COUNTY FLASHING LIGHT SIGNAL N &amp; P BELT LINE RR NEAR GILMERTON</u>
A6563	0013-064-002 2064-02	<u>NORFOLK COUNTY FR: 0.151 MI N OF INT RTE 13 TO 0.152? MI S OF INT RTE 13</u>
A7926	0464-131-101 RW202	<u>FR 0.929 MI N INTERSECTION RTE 64 TO: 0.183 MI SOUTH OF PARK AVE</u>
A9331	6013-131-101	<u>FR: 2.962 MI W OF W.C.L. OF CHESAPEAKE TO: 1.592 MI E OF E.C.L. OF NANSEMOND</u>
A21012	6013-131-102	<u>FR: 1.592 MI E OF E.C.L. OF SUFFOLK TO: 0.328 MI E INT RTE 264 &amp; EXIST RTE 13 (BOWERS HILL INTERCHANGE)</u>



COMMONWEALTH OF VIRGINIA  
DEPARTMENT OF HIGHWAYS

PLAN AND PROFILE OF PROPOSED  
STATE HIGHWAY

NORFOLK COUNTY  
FROM 1.187 M.I. E. OF INT. RT. 58 NEAR BOWERS HILL TO INT. RT. 27

SECT. EW  
FROM 1.187 M.I. E. OF INT. RT. 58 NEAR BOWERS HILL  
TO 1.676 M.I. E. OF INT. RT. 58  
SECT. A-1 W  
FROM 1.679 M.I. E. OF INT. RT. 58 TO 0.707 M.I. W. OF INT. RT. 27  
SECT. A-2 W  
FROM 0.540 M.I. W. OF INT. RT. 27 TO INT. RT. 27

INDEX OF SHEETS

Sheet No. / Title	Sta. From	Sta. To	Scale
1 / 1.187 to 1.676 M.I. E. of Int. Rt. 58	41+00	41+00	1" = 40'
2 / 1.676 to 1.679 M.I. E. of Int. Rt. 58	41+00	41+00	1" = 40'
3 / 1.679 to 1.680 M.I. E. of Int. Rt. 58	41+00	41+00	1" = 40'
4 / 1.680 to 1.681 M.I. E. of Int. Rt. 58	41+00	41+00	1" = 40'
5 / 1.681 to 1.682 M.I. E. of Int. Rt. 58	41+00	41+00	1" = 40'
6 / 1.682 to 1.683 M.I. E. of Int. Rt. 58	41+00	41+00	1" = 40'
7 / 1.683 to 1.684 M.I. E. of Int. Rt. 58	41+00	41+00	1" = 40'
8 / 1.684 to 1.685 M.I. E. of Int. Rt. 58	41+00	41+00	1" = 40'
9 / 1.685 to 1.686 M.I. E. of Int. Rt. 58	41+00	41+00	1" = 40'
10 / 1.686 to 1.687 M.I. E. of Int. Rt. 58	41+00	41+00	1" = 40'
11 / 1.687 to 1.688 M.I. E. of Int. Rt. 58	41+00	41+00	1" = 40'
12 / 1.688 to 1.689 M.I. E. of Int. Rt. 58	41+00	41+00	1" = 40'
13 / 1.689 to 1.690 M.I. E. of Int. Rt. 58	41+00	41+00	1" = 40'
14 / 1.690 to 1.691 M.I. E. of Int. Rt. 58	41+00	41+00	1" = 40'
15 / 1.691 to 1.692 M.I. E. of Int. Rt. 58	41+00	41+00	1" = 40'
16 / 1.692 to 1.693 M.I. E. of Int. Rt. 58	41+00	41+00	1" = 40'
17 / 1.693 to 1.694 M.I. E. of Int. Rt. 58	41+00	41+00	1" = 40'
18 / 1.694 to 1.695 M.I. E. of Int. Rt. 58	41+00	41+00	1" = 40'
19 / 1.695 to 1.696 M.I. E. of Int. Rt. 58	41+00	41+00	1" = 40'
20 / 1.696 to 1.697 M.I. E. of Int. Rt. 58	41+00	41+00	1" = 40'
21 / 1.697 to 1.698 M.I. E. of Int. Rt. 58	41+00	41+00	1" = 40'
22 / 1.698 to 1.699 M.I. E. of Int. Rt. 58	41+00	41+00	1" = 40'
23 / 1.699 to 1.700 M.I. E. of Int. Rt. 58	41+00	41+00	1" = 40'
24 / 1.700 to 1.701 M.I. E. of Int. Rt. 58	41+00	41+00	1" = 40'
25 / 1.701 to 1.702 M.I. E. of Int. Rt. 58	41+00	41+00	1" = 40'
26 / 1.702 to 1.703 M.I. E. of Int. Rt. 58	41+00	41+00	1" = 40'
27 / 1.703 to 1.704 M.I. E. of Int. Rt. 58	41+00	41+00	1" = 40'
28 / 1.704 to 1.705 M.I. E. of Int. Rt. 58	41+00	41+00	1" = 40'
29 / 1.705 to 1.706 M.I. E. of Int. Rt. 58	41+00	41+00	1" = 40'
30 / 1.706 to 1.707 M.I. E. of Int. Rt. 58	41+00	41+00	1" = 40'
31 / 1.707 to 1.708 M.I. E. of Int. Rt. 58	41+00	41+00	1" = 40'
32 / 1.708 to 1.709 M.I. E. of Int. Rt. 58	41+00	41+00	1" = 40'
33 / 1.709 to 1.710 M.I. E. of Int. Rt. 58	41+00	41+00	1" = 40'
34 / 1.710 to 1.711 M.I. E. of Int. Rt. 58	41+00	41+00	1" = 40'
35 / 1.711 to 1.712 M.I. E. of Int. Rt. 58	41+00	41+00	1" = 40'
36 / 1.712 to 1.713 M.I. E. of Int. Rt. 58	41+00	41+00	1" = 40'
37 / 1.713 to 1.714 M.I. E. of Int. Rt. 58	41+00	41+00	1" = 40'
38 / 1.714 to 1.715 M.I. E. of Int. Rt. 58	41+00	41+00	1" = 40'
39 / 1.715 to 1.716 M.I. E. of Int. Rt. 58	41+00	41+00	1" = 40'
40 / 1.716 to 1.717 M.I. E. of Int. Rt. 58	41+00	41+00	1" = 40'
41 / 1.717 to 1.718 M.I. E. of Int. Rt. 58	41+00	41+00	1" = 40'
42 / 1.718 to 1.719 M.I. E. of Int. Rt. 58	41+00	41+00	1" = 40'
43 / 1.719 to 1.720 M.I. E. of Int. Rt. 58	41+00	41+00	1" = 40'
44 / 1.720 to 1.721 M.I. E. of Int. Rt. 58	41+00	41+00	1" = 40'
45 / 1.721 to 1.722 M.I. E. of Int. Rt. 58	41+00	41+00	1" = 40'
46 / 1.722 to 1.723 M.I. E. of Int. Rt. 58	41+00	41+00	1" = 40'
47 / 1.723 to 1.724 M.I. E. of Int. Rt. 58	41+00	41+00	1" = 40'
48 / 1.724 to 1.725 M.I. E. of Int. Rt. 58	41+00	41+00	1" = 40'
49 / 1.725 to 1.726 M.I. E. of Int. Rt. 58	41+00	41+00	1" = 40'
50 / 1.726 to 1.727 M.I. E. of Int. Rt. 58	41+00	41+00	1" = 40'
51 / 1.727 to 1.728 M.I. E. of Int. Rt. 58	41+00	41+00	1" = 40'
52 / 1.728 to 1.729 M.I. E. of Int. Rt. 58	41+00	41+00	1" = 40'
53 / 1.729 to 1.730 M.I. E. of Int. Rt. 58	41+00	41+00	1" = 40'
54 / 1.730 to 1.731 M.I. E. of Int. Rt. 58	41+00	41+00	1" = 40'
55 / 1.731 to 1.732 M.I. E. of Int. Rt. 58	41+00	41+00	1" = 40'
56 / 1.732 to 1.733 M.I. E. of Int. Rt. 58	41+00	41+00	1" = 40'
57 / 1.733 to 1.734 M.I. E. of Int. Rt. 58	41+00	41+00	1" = 40'

CROSS SECTIONS  
DESTROYED 1983

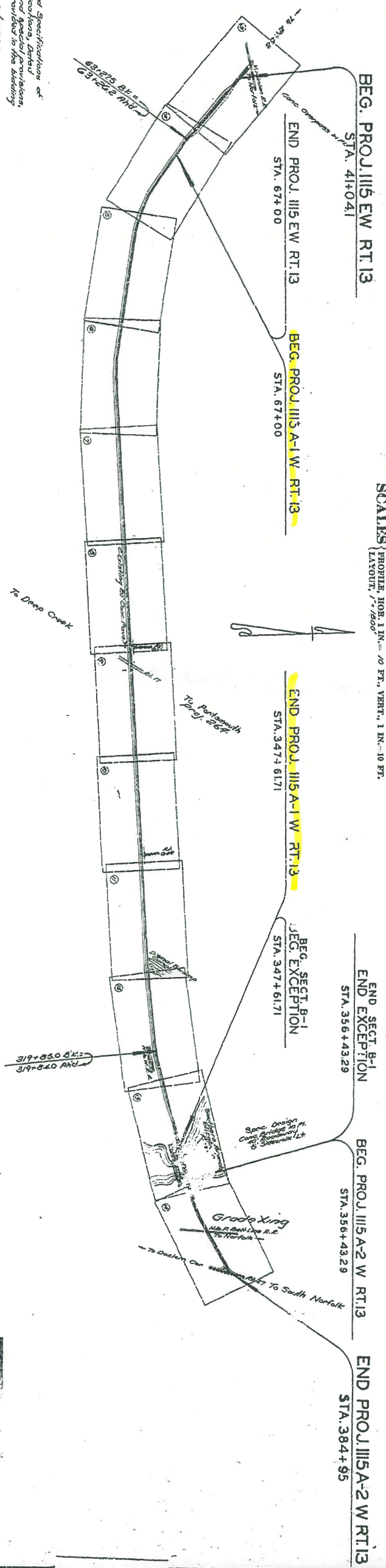

This project to be constructed under the Standard Specifications of the Virginia Department of Highways, Road Specifications, dated January 1, 1968, and additional specifications and special provisions, proposed and approved by the Board of Supervisors, as provided in the bidding proposal and contract. All curves are to be super-elevated in accordance with the Standard Method, except where otherwise noted.

CONVENTIONAL SIGNS

STATE LINE	LIVE OR EMBANKMENT
COUNTY LINE	BRIDGES
CITY, TOWN OR VILLAGE	CULVERTS
RIGHT OF WAY LINE	DROP INLET
PERCE LINE	TROLLEY POLES
UNFENCED PROPERTY LINE	POWER POLES
FENCED PROPERTY LINE	TELEPHONE OR TELEGRAPH POLES
TRAVELED WAY	MARSH
GUARD RAIL	HEEDGE
RETAINING WALL	WOODS
RAILROADS	GROUND ELEVATION
BASE OR SURVEY LINE	GRADE ELEVATION
	POLES WITHIN CONSTRUCTION LIMITS

Sect. EW  
Equalities = +13 Ft.  
Total Net Length = 259720 Ft. = 0.492 Miles

Sect. A-1 W  
Equalities = +10 Ft.  
Total Net Length = 890227 Ft. = 5.315 Miles

Secondary Road Connections  
Total Net Length = 2440 Ft. = 0.046 Miles

Sect. A-2 W  
Equalities = None  
Total Net Length = 288171 Ft. = 0.540 Miles

A 2801-1

APPROVED: [Signature] 1940  
CHIEF ENGINEER DEPARTMENT OF HIGHWAYS

RECOMMENDED FOR APPROVAL: [Signature]  
DISTRICT ENGINEER  
PUBLIC ROADS ADMINISTRATION - FEDERAL WORKS AGENCY

APPROVED: [Signature]  
COMMISSIONER  
PUBLIC ROADS ADMINISTRATION - FEDERAL WORKS AGENCY











